

Amenity Center
Renderings

PRESENTED NOVEMBER 2025





All renderings, maps, and plans are conceptual and subject to change without notice. Actual development details may vary, and the developer reserves the right to make modifications at any time. 11/25



THE
NEHEMIAH
COMPANY



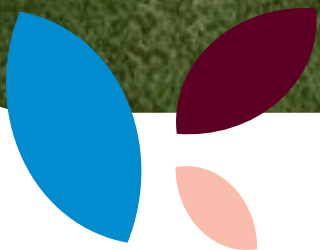

All renderings, maps, and plans are conceptual and subject to change without notice. Actual development details may vary, and the developer reserves the right to make modifications at any time. 11/25



THE
NEHEMIAH
COMPANY



2



All renderings, maps, and plans are conceptual and subject to change without notice. Actual development details may vary, and the developer reserves the right to make modifications at any time. 11/25



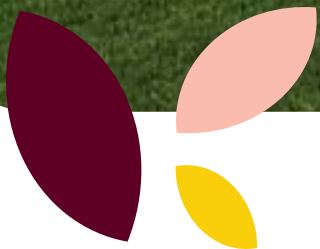

All renderings, maps, and plans are conceptual and subject to change without notice. Actual development details may vary, and the developer reserves the right to make modifications at any time. 11/25

4



All renderings, maps, and plans are conceptual and subject to change without notice. Actual development details may vary, and the developer reserves the right to make modifications at any time. 11/25



All renderings, maps, and plans are conceptual and subject to change without notice. Actual development details may vary, and the developer reserves the right to make modifications at any time. 11/25



THE
NEHEMIAH
COMPANY



6



talía

All renderings, maps, and plans are conceptual and subject to change without notice. Actual development details may vary, and the developer reserves the right to make modifications at any time. 11/25



THE
NEHEMIAH
COMPANY



7



All renderings, maps, and plans are conceptual and subject to change without notice. Actual development details may vary, and the developer reserves the right to make modifications at any time. 11/25



THE
NEHEMIAH
COMPANY





All renderings, maps, and plans are conceptual and subject to change without notice. Actual development details may vary, and the developer reserves the right to make modifications at any time. 11/25



THE
NEHEMIAH
COMPANY



9



All renderings, maps, and plans are conceptual and subject to change without notice. Actual development details may vary, and the developer reserves the right to make modifications at any time. 11/25



THE
NEHEMIAH
COMPANY



IO



All renderings, maps, and plans are conceptual and subject to change without notice. Actual development details may vary, and the developer reserves the right to make modifications at any time. 11/25



THE
NEHEMIAH
COMPANY

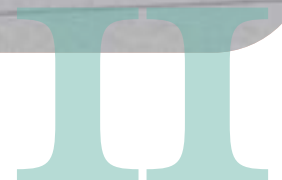



All renderings, maps, and plans are conceptual and subject to change without notice. Actual development details may vary, and the developer reserves the right to make modifications at any time. 11/25



12



All renderings, maps, and plans are conceptual and subject to change without notice. Actual development details may vary, and the developer reserves the right to make modifications at any time. 11/25



13



All renderings, maps, and plans are conceptual and subject to change without notice. Actual development details may vary, and the developer reserves the right to make modifications at any time. 11/25



THE
NEHEMIAH
COMPANY



14



All renderings, maps, and plans are conceptual and subject to change without notice. Actual development details may vary, and the developer reserves the right to make modifications at any time. 11/25



THE
NEHEMIAH
COMPANY



15

 talía

All renderings, maps, and plans are conceptual and subject to change without notice. Actual development details may vary, and the developer reserves the right to make modifications at any time. 11/25



THE
NEHEMIAH
COMPANY



16



All renderings, maps, and plans are conceptual and subject to change without notice. Actual development details may vary, and the developer reserves the right to make modifications at any time. 11/25



17



All renderings, maps, and plans are conceptual and subject to change without notice. Actual development details may vary, and the developer reserves the right to make modifications at any time. 11/25

 THE
NEHEMIAH
COMPANY



I8



All renderings, maps, and plans are conceptual and subject to change without notice. Actual development details may vary, and the developer reserves the right to make modifications at any time. 11/25



THE
NEHEMIAH
COMPANY



19

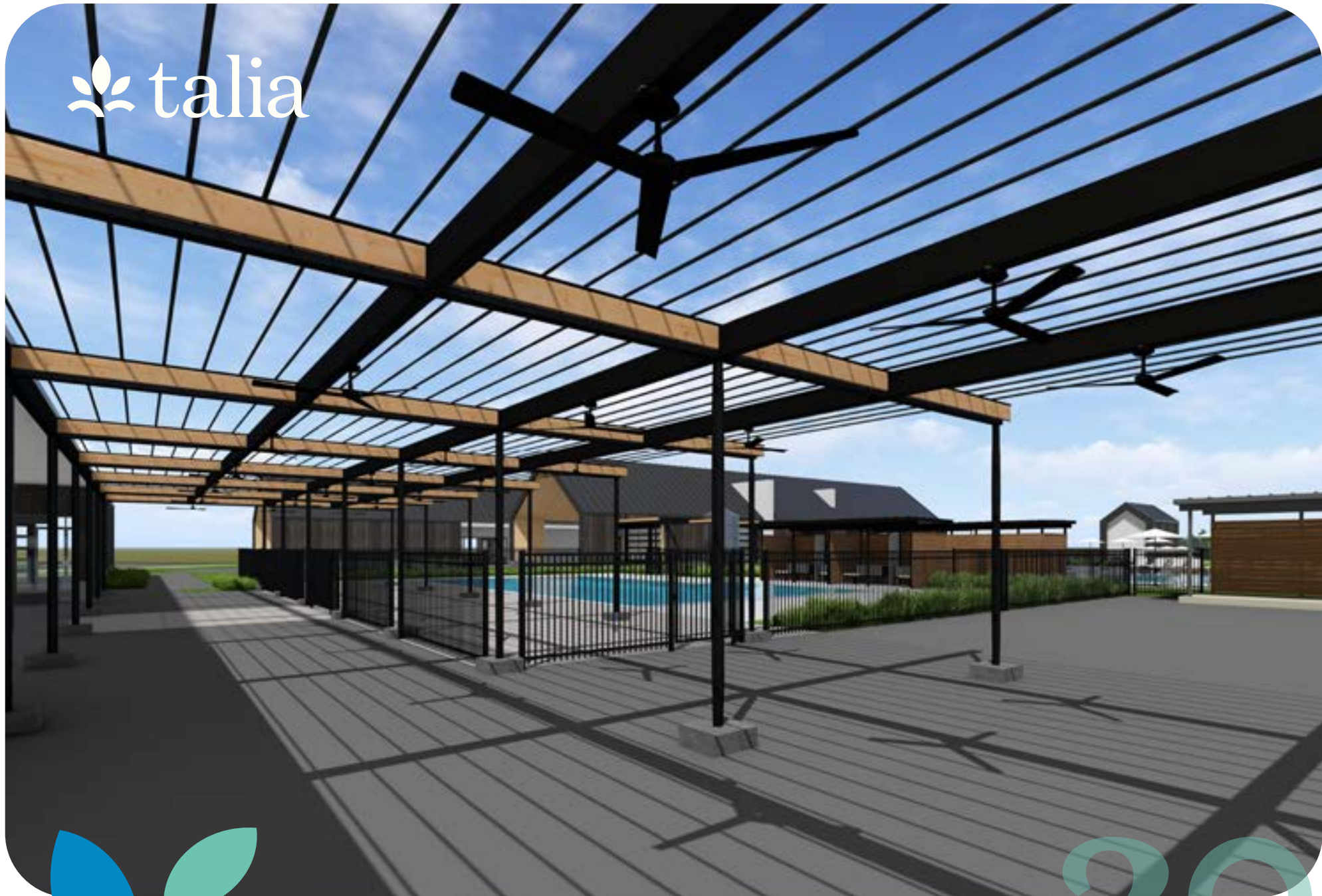

All renderings, maps, and plans are conceptual and subject to change without notice. Actual development details may vary, and the developer reserves the right to make modifications at any time. 11/25



THE
NEHEMIAH
COMPANY



20

The logo for 'talía' features a stylized leaf icon to the left of the word 'talía' in a lowercase, serif font.

All renderings, maps, and plans are conceptual and subject to change without notice. Actual development details may vary, and the developer reserves the right to make modifications at any time. 11/25

 THE
NEHEMIAH
COMPANY



21

The logo for 'talía' features a stylized white leaf icon to the left of the word 'talía' in a lowercase, serif font.

All renderings, maps, and plans are conceptual and subject to change without notice. Actual development details may vary, and the developer reserves the right to make modifications at any time. 11/25



THE
NEHEMIAH
COMPANY



22